

Socket outlets for applications - TECHNICAL CHARACTERISTICS

Prese per applicazioni

- **01298 - 01298.N**
 - overall dimensions: 40,5 mm
 - flush depth: 25,5 mm

- **01299 - 01299.N**
 - overall dimensions: 40,5 mm
 - flush depth: 25,5 mm

- **01303 - 01303.N**
 - overall dimensions: 40 mm
 - flush depth: 29,5 mm

Conformity to Standards

CEI 23-50 (IEC 60884-1) Standard

Dimensions (in mm)

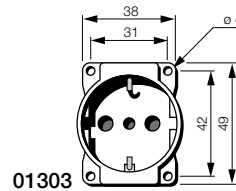
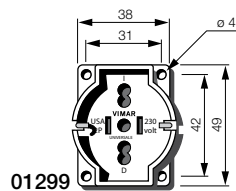
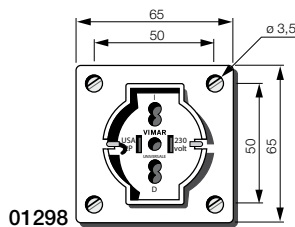

Socket outlets for applications

SICURY socket outlet 250 V~, universal, for applications

01298 .N 2P+E 16 A 250 V~ SICURY socket outlet, universal, for 2P 2.5 A Europlugs, for 2P and 2P+E 10 A and 16 A Italian standard plugs, for 2P+E 16 A German standard plugs, and for 2P 15 A 125 V~ American standard plugs with non-polarized flat blades - monobloc construction. Earth connection is not realized with 2P+E 16 A 250 V~ French standard plug. Delivered with fixing accessories: 4 wooden screws and 4 metric screws with nut.



01298
ivory



01298.N
black

SICURY socket outlet 250 V~, universal, for applications

01299 .N Insert of 2P+E 16 A 250 V~ SICURY socket outlet, universal, for 2P 2.5 A Europlugs, for 2P and 2P+E 10 A and 16 A Italian standard plugs, for 2P+E 16 A 250 V~ German standard plugs, and for 2P 15 A 125 V~ American standard plugs with non-polarized flat blades. Earth connection is not realized with 2P+E 16 A 250 V~ French standard plug



01299
ivory



01299.N
black

P30 socket outlet 250 V~, for applications

01303 .N Insert of 2P+E 16 A SICURY socket outlet Italian standard P30 (lateral and central earth contacts)



01303
ivory



01303.N
black